

# VISUAL INSTALLATION GUIDELINES FOR

**SLOAN**



# SOLIS<sup>®</sup> CONVERSION KIT

**1**

Loosen and remove top screws of G2 Flushometer along with the outer cover assembly.

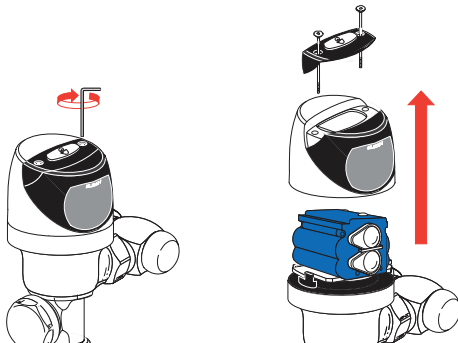

**2**

Disconnect wire clip from battery door and remove module from inner cover assembly.

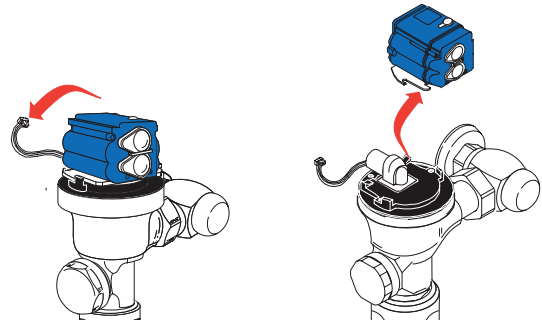

**3**

Mount SOLIS<sup>®</sup> module on inner cover assembly. Reconnect the plastic clip on the battery door. Remove tape located over sensor eyes.

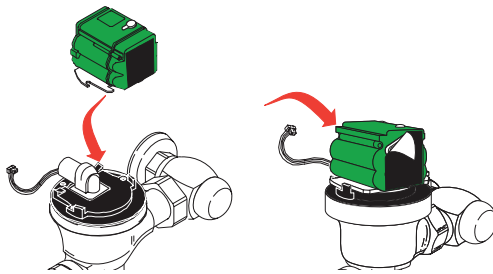

**4**

Secure SOLIS<sup>®</sup> cover assembly with screws.

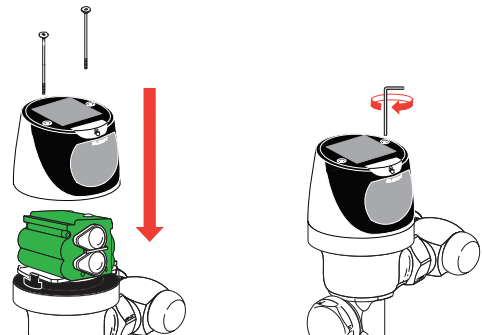

**5**

Install the SOLIS<sup>®</sup> wall plates. Recommended locations shown below. Installation complete.

*Centered over Flushometer*



*On Stall Door*

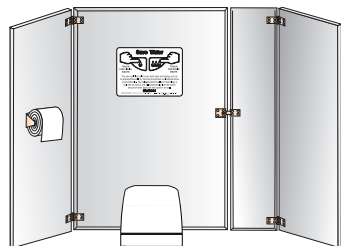

**SLOAN**

10500 SEYMOUR AVE. - FRANKLIN PARK, IL 60131  
PHONE: 1-800-9-VALVE-9 - FAX: 1-800-447-8329  
<http://www.sloanvalve.com>

**Air Delights**

11170 SW 5TH STREET, SUITE 100 - BEAVERTON, OR 97005  
PHONE: 1-800-440-5556 - FAX: 1-503-643-8224  
<http://www.airdelights.com> - Customer\_Service@AirDelights.com

The information contained in this document is subject to change without notice.

We recommend that you review our SOLIS<sup>®</sup> or G2 Installation Instruction Manual and Maintenance Guides for complete instructions including Rough-in Dimensions, Specifications, Troubleshooting Guide and Replacement Parts.

Call our Engineers for additional Information at 1-888-SLOAN-14 (1-888-756-2614) or fax them at 1-800-737-3061.